

CARTONMASTER® AP-106

外型基礎圖

<<FLOOR PLAN

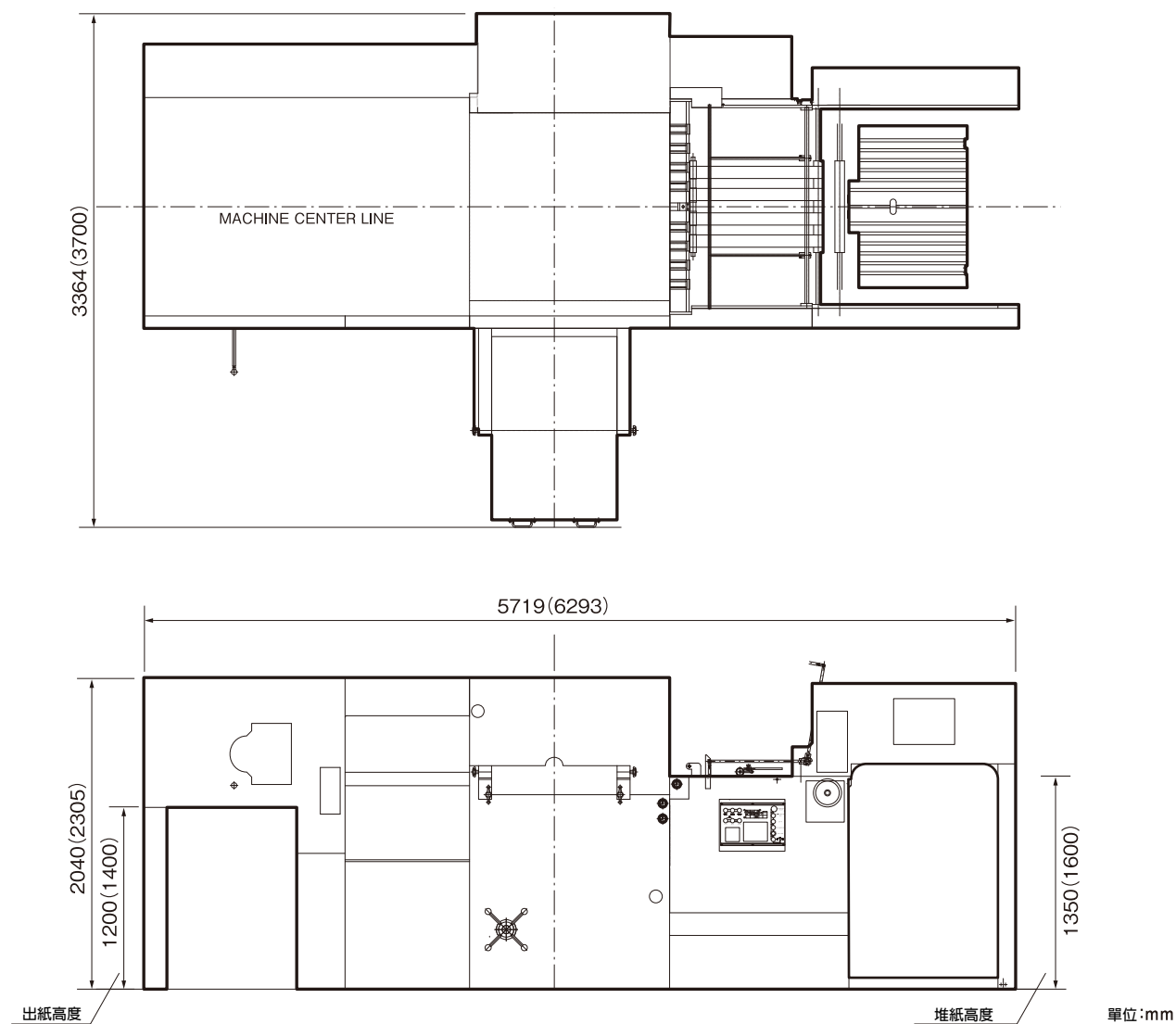

※ 數值為 AP-106。 () 內為 AP-115。 ※ AP-106 與 AP-115 尺寸皆不相同。
Figure with * mark for AP-106 Figure in () for AP-115 Overview of AP-115 is not same as AP-106

規格

<<SPECIFICATION

	AP-106	AP-115
最大紙張尺寸	MAXIMUM SHEET SIZE 740×1060mm	850×1150mm
最小紙張尺寸	MINIMUM SHEET SIZE *270×400mm	400×450mm
最大裁切尺寸	MAXIMUM CUTTING SIZE 730×1050mm	840×1140mm
最小咬紙寬度	MINIMUM GRIPPER MARGIN 8mm	
切框內緣尺寸	INSIDE CHASE 764×1120mm	874×1240mm
最大模切壓力	MAXIMUM OPERATIONAL PRESSURE 250tons	350tons
紙張厚度	MAXIMUM SHEET THICKNESS 0.1~1.5mm	B瓦楞
最高模切速度	MAXIMUM SPEED 爪式 7000i.p.h 釘式 6000i.p.h	
總電力	REQUIRED POWER SUPPLY 19kw	23kw
機械重量	NET WEIGHT OF MACHINE 13tons	18tons

規格如有變動，恕不另行通知。 The specifications are subject to alteration without notice.

PAKTEK
譽邦實業有限公司
PAKTEK INDUSTRIAL CO., LTD.

桃園市新屋區上青埔58之9號
No. 58-9, Shangqingpu, Xinwu Dist., Taoyuan City 327, Taiwan
TEL : +886 3-477-0110 FAX : +886 3-477-0050
E-mail : paktek@paktek.com.tw

ASAHI

CARTONMASTER®

<<AUTOMATIC DIECUTTING AND CREASING MACHINE



AP-106

PREMIUM

AP-106,115

爪式、釘式
You can choose Gripper or Spike.

譽邦實業有限公司
PAKTEK INDUSTRIAL CO., LTD.

CARTONMASTER®

AP-106 PREMIUM 7000i.p.h.

**爪式與釘式。兩種送紙方式可供選擇。
更多創新的新技術，使產能向上提升。**

You can choose Gripper or Spike. 2 types of transfer systems.
More new technology and improvement for High Productivity

- 可配備清廢裝置。
- 具有更高剛性的夾具可確保高生產率。
- 廣法覆蓋薄紙到紙板的厚度。
- 豐富的選購配件，擴展更多加工用途。

- Blanking unit is now available.
- Gripper bar with more rigidity keep reliable production.
- Wide range application from thinner paper also even corrugated board
- Productive options provide job with flexibility



ASAHI

機器照片包含選配規格
The machine installed units of optional specifications

CARTONMASTER® AP-106 PREMIUM

給紙部

FEEDER

採用追求高速性、功能性、操作性、高鋼性的新開發的送紙器「上送飛達」



- 新型吸盤送紙頭 無論厚紙、薄紙、紙器皆可穩定送紙。
- 方便的控制系統提供快速準確的送紙條件。
- 不停機送紙系統連續送紙。

- Sucker head on the latest model enables constant feeding of thick as well as thin paper or folding cartons.
- Convenient controlling systems provide rapid and accurate feeding condition.
- Continuous sheet feeding by non-stop feeding system.



給紙搬送桌

FEEDER TRANSFER TABLE

提高紙張品質、速度、操作性和工作效率



- 新設計的推/拉針，進一步提高精準度。
- 可從操作側調整精準度。
- 送紙輪架的位置可通過操作側的把手做調整。

- Newly designed push and pull side lay has been adopted for greater registration.
- Tolerance adjustment can be made at operation side.
- Positioning of feed roller frame can be adjusted by hand wheel at operation side.

壓力部

PRESS

對應高速及強化鋼性的新設計

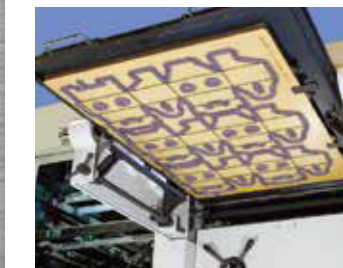

- 簡單的切框設定和高鋼性切板。
- 切框由氣動鎖定裝置牢牢夾緊。
- 一鍵式橫桿縮短設定時間。

- Easy set up chase and heavy-duty cutting plate has been adopted.
- Cutting chase, firmly clamped by pneumatic locking devices.
- Set time reduction is available by One-touch cross bar.

清廢部

STRIPPING

提高設定速度



- 可配備清廢裝置。
- 雙清廢裝置去廢針去除剝離廢邊紙。
- 公模、上針、下針完全去除廢紙。

- Blanking unit is now available.
- Stripping of the waste by double-movement positive pin system.
- Male form, upper and lower pins enable perfect stripping.

收紙部

DELIVERY

追求紙張整齊並提高可操作性



- 可在產品排出側進行機器操作。
- 各部均採用一鍵式調節機構，大幅提高操作性及工作效率。
- 深入研究操作者的工作模式，減輕了操作者的負擔。
- 電動式卸載系統。

- New operator control station located at delivery section.
- One-touch adjustment system at each section for much improvement of operability and workability.
- Ergonomically designed for easy operation.
- Motorized unloading system.



操作控制面板 OPERATION CONTROL PANEL

支援操作人員、機器狀況一目了然



- 對操作者友善的觸控面板，持續監控每個感測器的狀態並顯示機器狀態。
- 收紙升降台控制可做五段式切換。
- 機器停止紀錄和維護清單。

- Operator friendly touch screen showing machine status by constant monitoring of sensor conditions.
- 5 degree change for control of feeder hoist ascent and delivery table descent.
- Machine stop record indication and visual fault finding diagnostic "Maintenance Menu".